

Tools Required

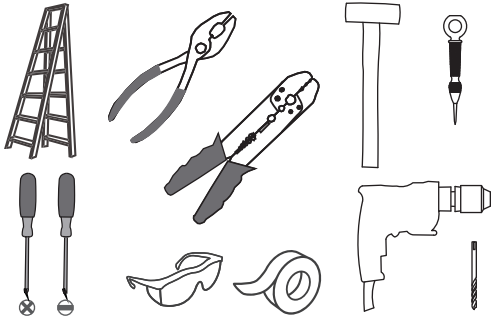

Light Source

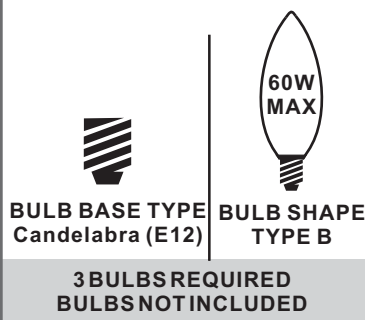

Warnings and Cautions

Turn off the electricity at the circuit breaker before installation. Consult a licensed electrician if in doubt about installation.



Turn off power to the fixture and allow the bulbs to cool before replacing.

Package Contents

Preparation: Identify and inspect all parts before beginning the installation.

Missing or damaged parts? Contact your original place of purchase.

PARTS BAG

-  **A** Mounting Screw x 3
-  **B** Wire Connector x 3

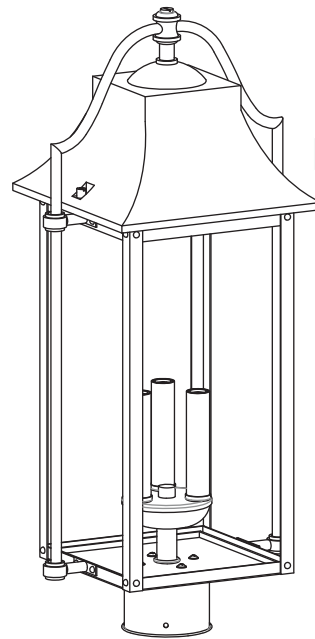

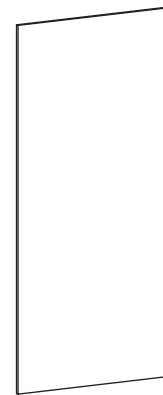

C Fixture Body x 1

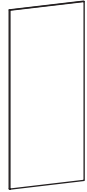

D Glass Shade x 4

Table of Contents

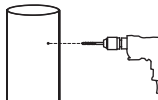
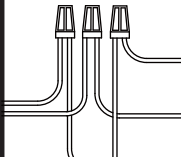
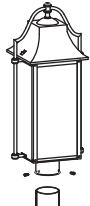
Glass Panel	Bulb	Drill Holes	Wiring	Fixture Body
				
STEP 1	STEP 2	STEP 3	STEP 4	STEP 5

STEP 1

- 1 ----- 2 ----- 3

Remove fixture hood

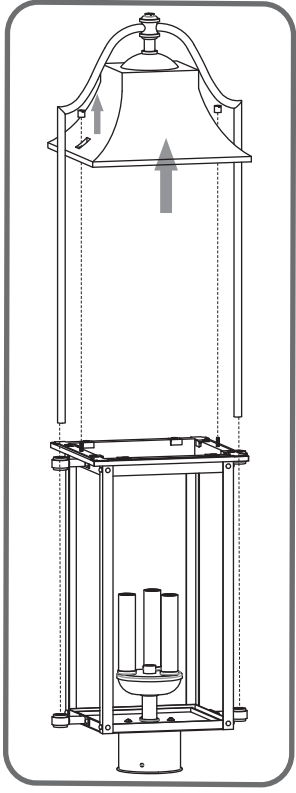

Remove Tabs

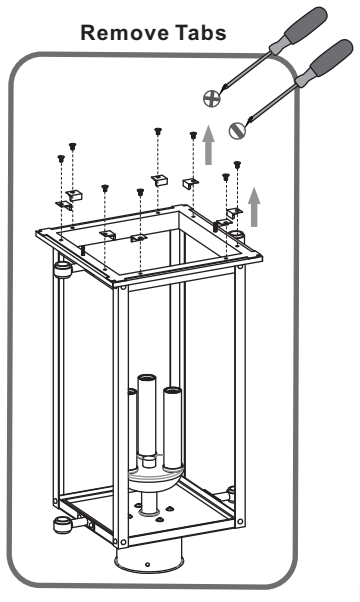

Install glass panels

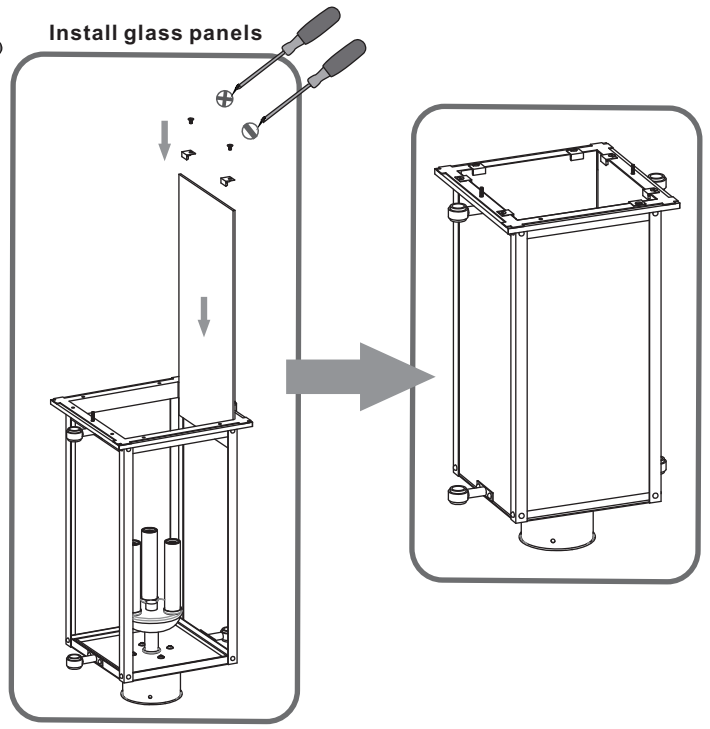

STEP 2

- 1 ----- 2

Install bulbs

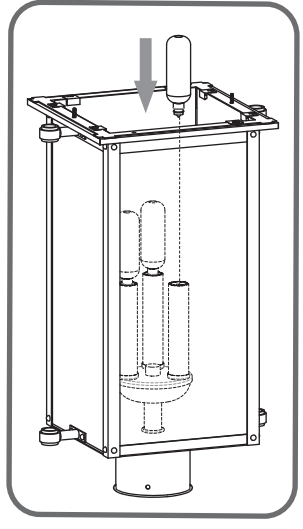

Install fixture hood

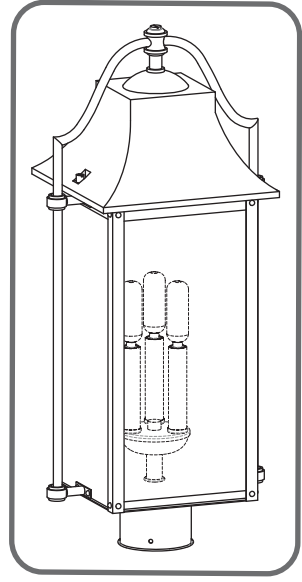
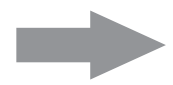
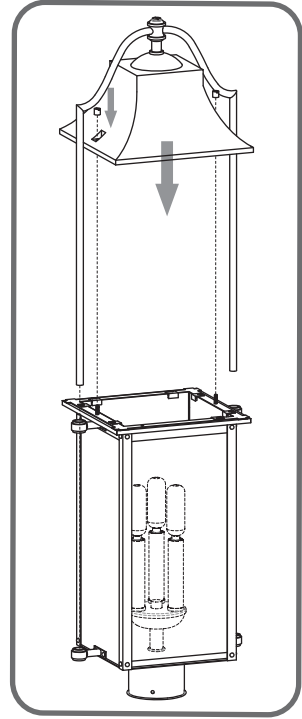

STEP 3

1

Step 1
Place Post Fitter to Post

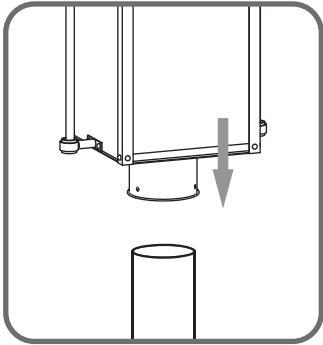

2

Step 2-3
Mark Mounting Holes Location on Post

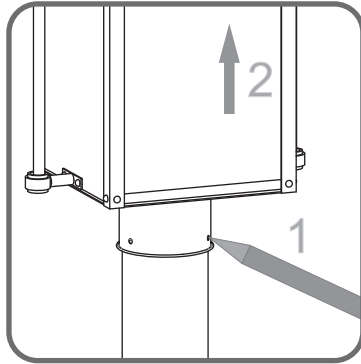

3

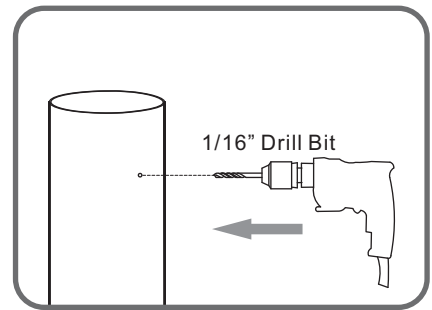
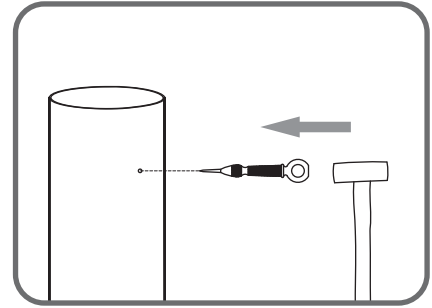

Step 4
Drill Holes

4

STEP 4

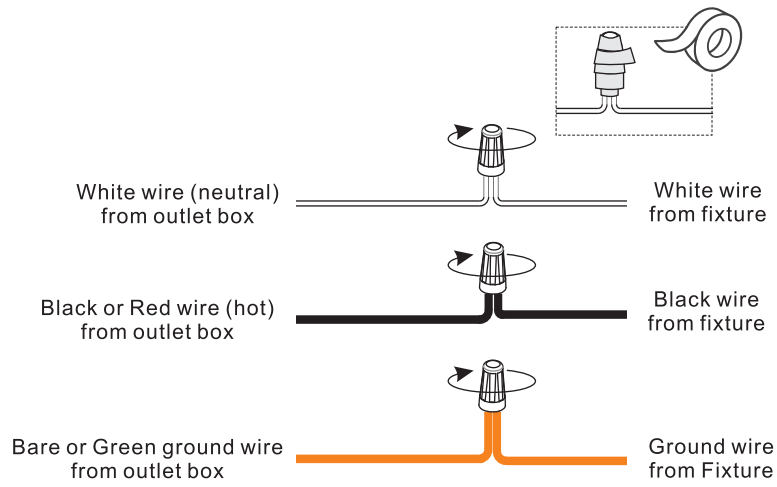

STEP 5

