

S06101

INSTALLATION INSTRUCTIONS SHEET

START FROM HERE

- Make sure power is completely off at the fuse box.
- Have your fixture installed by a qualified licensed electrician
- Prepare everything in clear area.
- Wear gloves at all times during this installation.
- Read instructions carefully before you start assembly.
- Keep this instruction sheet for future reference.

Technical Support: 1-844-628-8368

Please Note:

- All Matteo Lighting fixtures come with pre-wired module(s).
- Unless instructed to do so, please do not touch any part of the module(s) as any unnecessary contact with the module could cause permanent damage.

THIS LUMINAIRE MUST BE MOUNTED OR SUPPORTED INDEPENDENTLY OF AN OUTLET BOX

CE LUMINAIRE NE DOIT PAS ETRE MONTE SUR UNE BOITE DE SORTIE NI SUPPORTE PAR UNE TELLE BOITE

- 1 Ensure main supply is switched off.
- 2 Lock the ground screw (5) and mounting strap (4) to the round mounting strap (3), have the mounting screw (2) through the round mounting strap (3) and screw into J-box (1) (not included).
- 3 Connect wires (6, 7) using wires nuts, using the mounting screw (9) to lock the back plate (8) on the mounting strap.
- 4 Put the glass (12) on the socket (11) and screw the socket cup (10) on the socket to fix the glass (12).
- 5 Install the bulb (13) (not included) on the socket (11).

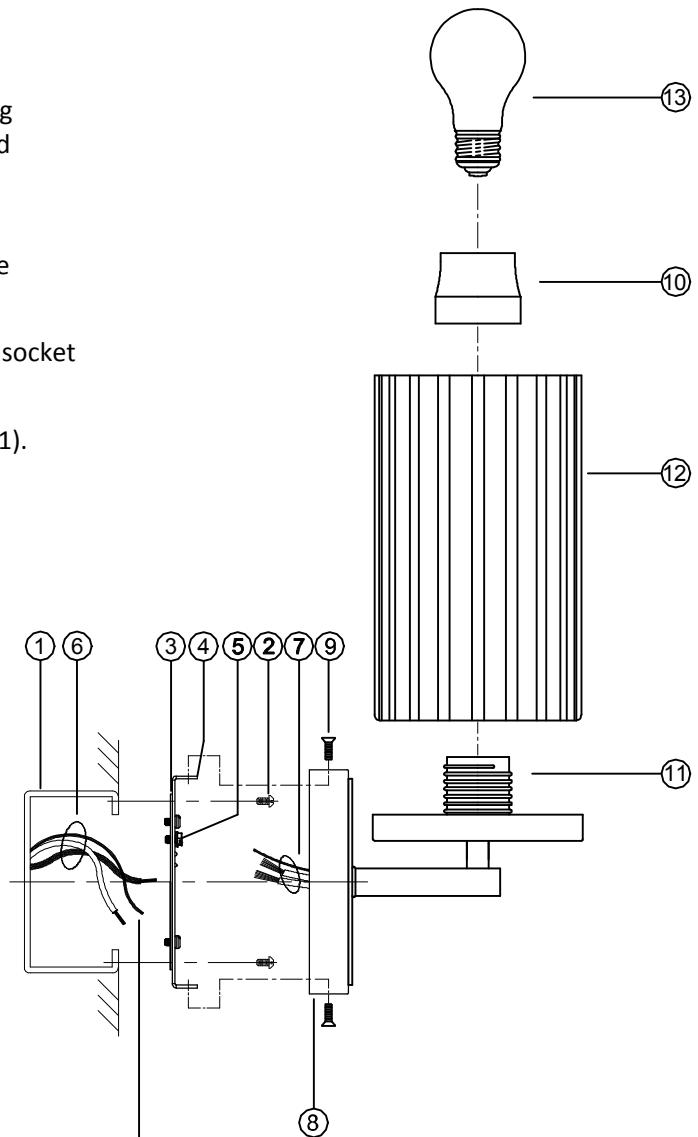
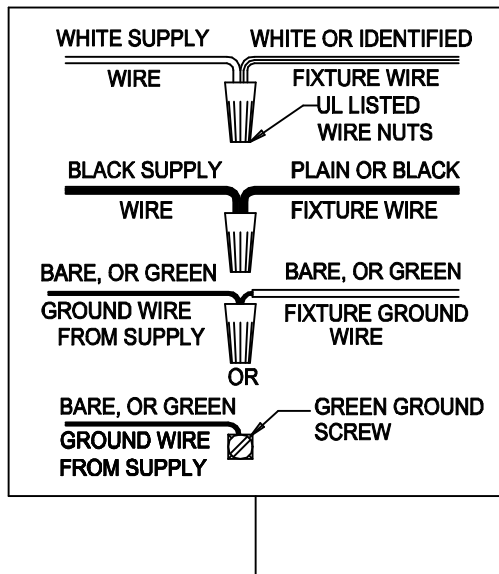

WARNING:

This fitting must be earthed.
Disconnect power and allow fitting to cool down before cleaning or changing the lamp.