

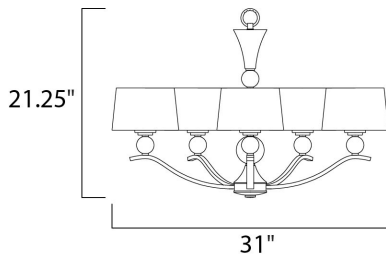

**PRODUCT DESCRIPTION**

Cool, clean and contemporary are just a few words to describe the Rondo collection. Rectangular arms are bent to form graceful curves and are finished in Polished Nickel. The sharpness of the frame is softened with the use of round crystal glass balls. The White fabric shades are fit with white diffusers that evenly light the room.



**MEASUREMENTS**

DIMENSION : 31" L x 31" W x 21.25" H  
 MAX OAH : 93.25" OAH  
 HANGING WEIGHT : 11.9 lb

**LAMPING**

INPUT VOLTAGE : 120V  
 LUMENS : 3,360 Rated  
 BULB : 5 x 60W Incandescent E12 Candelabra , 300W Total  
 BULB INCLUDED : (Not Included)  
 DIMMABLE : Yes

**FINISHES OPTION**



**GLASS**

White WT

**MATERIAL**

Steel + Fabric + Glass + Acrylic

**RATINGS**

cULus  
 Dry Location



**ADDITIONAL**

ADJUSTABLE  
 RATED LIFE 1500 Hours  
 OPERATING TEMPERATURE:  
 -20°C (-4°F), 40°C (104°F)

Always consult a qualified electrician before installing any lighting product.



**WESTERN DISTRIBUTION CENTER (HEADQUARTER)**  
 253 NORTH VINELAND AVE | CITY OF INDUSTRY, CA 91746

**EASTERN DISTRIBUTION CENTER**  
 4200 SHIRLEY DR. | ATLANTA, GA 30336

P. 626.956.4200 | F. 626.956.4225 | maximlighting.com