

Assembly Instruction Sheet #S -8004P44 For Style 8004P44

Tools Required: Flathead screwdriver, Phillips screwdriver, pliers, wire cutters, wire strippers, electrical tape, safety glasses.
Light Source: (7) E12 Candelabra Base Bulbs 80W Maximum (Not Included).
Individual Assembly Time: 15-30 minutes.
Preparation: Identify and inspect all parts before beginning installation. Check package content list and diagrams before to be sure all parts are present. If any parts are missing or damaged, do not attempt to assemble, install, or operate the fixture. Contact customer service for replacement parts.

⚠ Warnings and Cautions
 Turn off electricity at circuit breaker or main fuse box before installation. Consult a licensed electrician if in doubt. These instructions are provided for your safety. It is very important you read them completely before installing the fixture. We strongly recommend that a licensed, professional electrician perform the installation. Disconnect fixture from power source before replacing bulbs. Make sure bulbs are given sufficient time to cool before removal.

Package Contents

- 22mm*1PCS
70mm*1PCS
A Crystal X100
- 30mm*1PCS
B Crystal X64
- C** Fixture Body x1

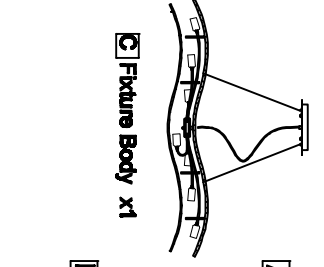

Hardware Contents

- | PART | DESCRIPTION | QUANTITY |
|------|------------------|----------|
| BB | Wire nut | 2pcs |
| CC | Outlet Box Screw | 2pcs |

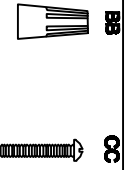

STEP1 - Release Crossbar from Fixture Body

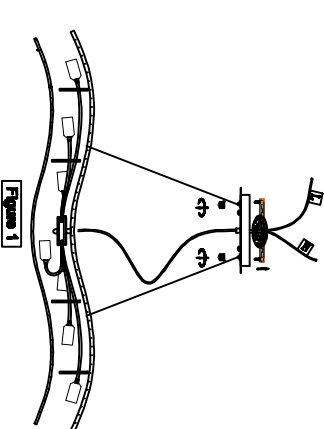

STEP1 - Attach Crossbar to Outlet Box.

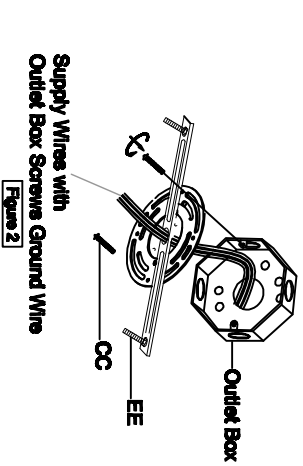

Supply Wires with
Outlet Box Screws Ground Wire

STEP 3 - Wire Connections

Align standard wire connectors to make all wire connections. Tied connectors will then be tightly joined together. Wrap each connection with approved electrical tape and carefully stuff all the connected wires into the Outlet Box.

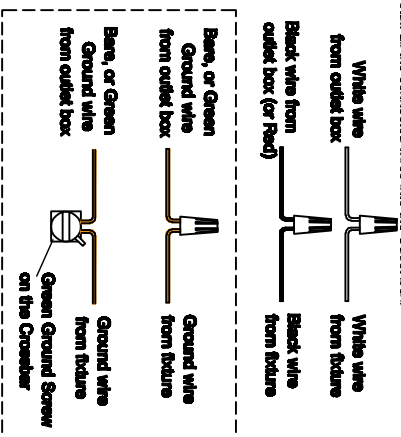

STEP 4 - Install Ceiling Canopy to Ceiling

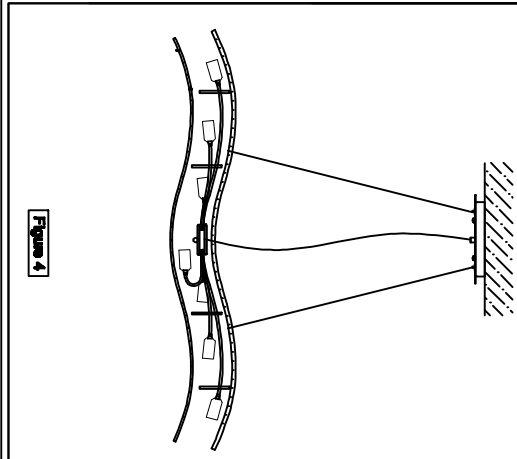

STEP 5 - Install Crystal and Bulbs.

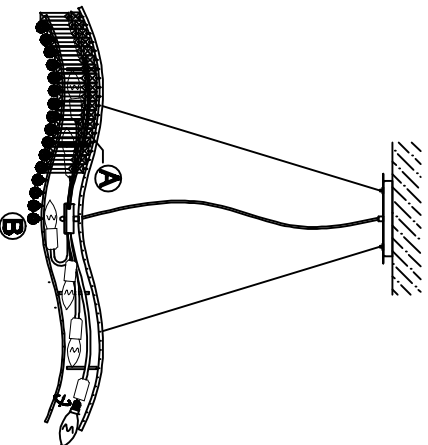

- 22mm*1PCS
70mm*1PCS
A Crystal X100
- 30mm*1PCS
B Crystal X64