



REMOVE OLD TOILET : Turn off the toilet supply valve and flush the toilet. If replacing supply valve, you will need to shut off the main water supply. Sponge out the remaining water from the bowl. Disconnect and remove the water supply line. Remove the mounting bolt nuts and washers and lift the toilet from the flange, plug the waste opening to prevent sewer gas from escaping, clean away the old wax from the flange area.

Before Beginning: Assuming that your bathroom has a four inch drain with a slotted toilet flange and a cold water supply line in place, to complete your installation you will need the following items not supplied: water supply line, water shut off valve (if replacing), sealant, 2- closet bolts, wax ring & toilet seat (Except for "Grab N Go" Packaging toilet, "Grab N Go" packaging includes Toilet Seat, Wax Ring, and Bolts.).

A Word of Caution: The new toilet is made of fine china like the best quality tableware. It is ruggedly constructed: However extra care should be exercised during installation when rough handling and the danger of dropped tools threaten to chip or crack it.

Installing the Toilet Bowl and Tank

1

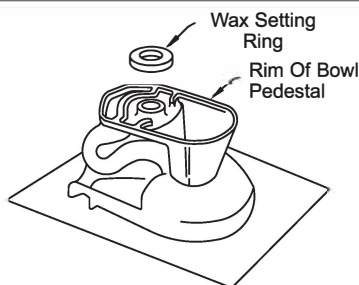

Clean the immediate floor area thoroughly. Insert the new toilet bolts in the slotted flange, bolt heads down. The toilet bowl should be placed on the floor upside down, on a soft material to prevent scratching. Place the wax ring evenly around waste flange (horn), with tapered end of the ring facing the toilet. Apply a thin bead of sealant around the toilet base.

2



Unplug the floor waste opening. Gently place the bowl, right side up, in position with the mounting bolts protruding through the holes in the toilet base. Press down with slight rocking motion on the top center with your full weight. Make sure the bowl is level. Loosely install the retainer washers and nuts. Side of washers marked "THIS SIDE UP" must face up. After confirming the bowl is level, tighten the nuts evenly and snugly. Install the caps on washers. (If necessary, cut the bolt height to size before installing the caps) Smooth the bead of sealant around the base. Remove excess sealant.

DO NOT OVERTIGHTEN NUTS, AS VITREOUS CHINA EASILY CHIPS AND CRACKS.

Pour water into the bowl to prevent sewer gas from escaping.

3

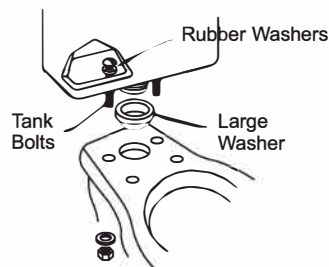

Remove the toilet tank from the packaging, be careful not to damage the tank lid. The tank should be turned upside down, on a soft material to prevent scratching. Place the large doughnut shaped washer snugly on the threaded tank outlet. Invert the toilet tank and set on the toilet bowl with the large doughnut washer centered on the bowl inlet. Place the bolts with the rubber washer through the tank holes, loosely place the metal washer and nut on the underside of the toilet tank flange. With the tank parallel to the wall, alternately finger tighten the nuts. Using pliers, alternately give the nuts a half turn until the tank is in contact with the bowl piers.

CAUTION: DO NOT OVERTIGHTEN TO AVOID CRACKING THE VIREOUS CHINA.

4

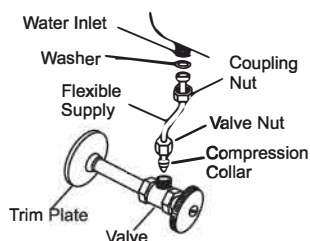

Connect the cold water supply line (not supplied) to the tank with your straight or angled stop. Place the washer, and then attach the plastic nut to the tank water inlet. If necessary, slightly bend the pipe to fit into the inlet hole on the water inlet. Tighten all plastic nuts securely.

5

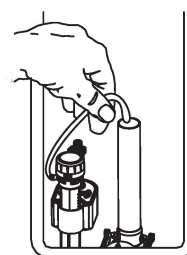

Connect the plastic tubing from the tip of the water inlet regulator into its holding ring inside the overflow tube. If necessary, excess may be trimmed to eliminate any leaks.

6

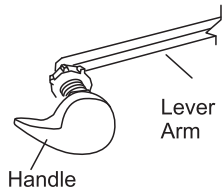

On certain models the flush lever must be installed. To do this remove the lever from the parts bag. Insert the lever through the hole in the tank. Thread the nut from the parts bag into the threaded shank. **NOTE:** If the lever is located on the left side of the tank, the threads are left-handed. To tighten, turn the nut counter-clockwise.

For tank models that have the lever located on the right side, install in the same way except this assembly has a right-hand thread. (Turn counter-clockwise.)

Tighten nut with a wrench to achieve a snug fit.

7 Adjusting Tank Water Level

IMPORTANT: Remove rubber band and tag from flapper . Turn on water supply, check for leaks.

Activate the handle (flush) and let the toilet cycle once. If needed, adjust the water to the desired level (marked inside the tank). **For major water level adjustments:** Remove tab by sliding it down from tube. Twist tube counterclockwise until it moves up and down freely. After water level adjustment is made, twist tube clockwise to lock then reinstall tab . **For minor water level adjustments:** Slide tab (located on the back side of fill valve) to the open position. Slide the float and cup assembly up (to raise water level) or down (to lower water level). Slide tab to the close position to lock float assembly. Turn adjustment rod to adjust the top surface of float to be flush with the top of cup . If bowl fails to siphon, an adjustment may be required with the lift chain . To adjust, remove the chain from the hook. Take up slack and place chain back on hook. Make sure chain is not too tight. Test flush cycle again, repeat procedure if necessary. Place cover onto tank.

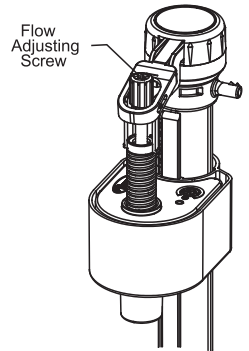

8 Place the cover on the tank. Place the plastic bolt covers firmly in place. Install the toilet seat in accordance with the manufacturers instructions.

9 Care and Cleaning of Vitreous China

Your new toilet is made of stain, acid and abrasion resistant vitreous china. But, like all fine finishes the china requires reasonable care. For day-to-day cleaning, wash with warm water, a soft cloth, and a mild detergent . On stubborn stains, use one of the powdered detergents , on a damp sponge or scouring pad of nylon, saran, or poly-ethylene. Never use abrasive scouring powders, cleansers, or pads as they tend to create microgrooves that dull the finish and allow dirt to work into the surface. Use if tank cleaning products containing calcium hypochlorite (chlorine) or any other reactive chemical shall constitute improper maintenance.

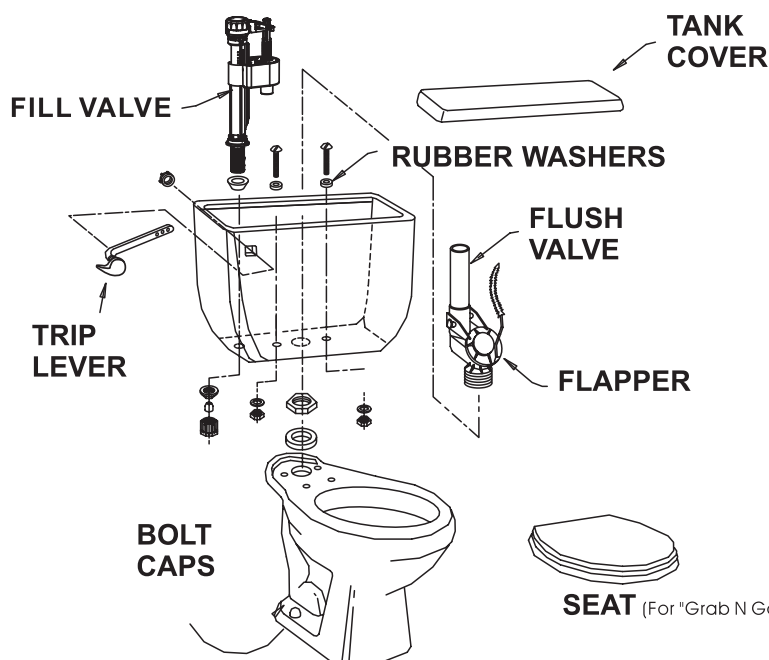

REPLACEMENT PARTS

Please keep this manual for future reference. Retain product invoice . Record the Model Number of the toilet in this booklet. This will assist when ordering replacement parts.



LIMITED WARRANTY

Vitreous China

Canton Bathware Vitreous China is warranted to the original consumer purchaser to be free from defects in material and workmanship for as long as the original consumer purchaser owns the home in which the toilet was first installed or for 5 years from the date of purchase.

Mechanical Parts

Mechanical parts of the **Canton** Bathware toilet are warranted to the original consumer purchaser to be free from defects in material and workmanship for 1 year from the date of purchase.

Toilet Care Tip: Over time, hard water deposits may clog toilet rim holes and trapways. To clean, purchase a commercial cleaner that's recommended for the removal of hard water deposits. Follow all instructions on the package.

Canton Bathware will replace, free of charge, during the applicable warranty period, any part or finish that proves defective in material and/or workmanship under normal installation, use and service. **Canton** Bathware recommends using a professional plumber for all installation and repair. Replacement parts may be obtained by emailing the address below, calling the number below or by writing to:

Compass Manufacturing International

Canton Bathware Product Service

6702 Enterprise Drive

Louisville, KY 40214

800.626.3525

www.cmiproduct.com

warranty@cmiproduct.com

Canton Bathware is a division of Compass Manufacturing International

Vitreous China Product Care

Rinse thoroughly and use a soft cloth to wipe the product dry after each use.

Regular Maintenance:

Remove stains using a cleaning product that contains mild abrasives; rinse and towel dry. Strong abrasive cleaners will scratch and dull the surface. Use toilet bowl cleaners on the inside of the bowl only. Do not use in-tank toilet cleaners as they can damage the flush valve or other working parts. Wipe any splashes of cleaner solutions from plastic or plated surfaces immediately.

Products to Consider

Comet Bathroom Cleanser

Formula 409 Antibacterial All Purpose

Windex Original

Soft Scrub Original